



ISO A - ISO B - Standard
ISO A - ISO B - Standard
ISO A - ISO B - Standard
ISO A - ISO B - Standard

Agriculture
Agricoltura
Ausführung Agrartechnik
Agriculture

Screw Together
Innesti a Vite
Schraubkupplungen
A Visser

Check Valves
Valvole Unidirezionali
Rückschläventile
Clapet Anti-retour

Diagnostic
Diagnostici
Diagnostik Kupplung
Diagnostic

Flat Face
Innesti Faccia Piana
Flachdichtend
Clapet à Face Plat

Multifaster
Multiconnessioni
Multikupplungen
Multifaster

Features	Caratteristiche	Merkmale	Caractéristiques
Connection by pulling back the sleeve	Connessione mediante arretramento ghiera parte femmina	Kuppeln durch Zurückziehen der Verriegelungshülse und Einstecken des Steckers	Connexion en poussant le coupleur mâle
Disconnection by pulling back the female sleeve	Disconnessione mediante arretramento ghiera parte femmina	Entkuppeln, durch Zurückziehen der Verriegelungshülse	Déconnexion en tirant la bague femelle
Shut off by poppet valve	Sistema di tenuta mediante valvola	Verschluß durch Kegelventil	Système d'étanchéité à clapet standard
Connection under pressure not allowed	Connessione in pressione non consentita	Kuppeln unter Druck nicht erlaubt	Connexion sous pression non autorisée
Disconnection under pressure not allowed	Disconnessione in pressione non consentita	Entkuppeln unter Druck nicht erlaubt	Déconnexion sous pression non autorisée
Interchangeability according to ISO 7241-1 Part B	Intercambiabilità secondo norme ISO 7241-1 Part B	Austauschbarkeit gemäß ISO 5271-1 Teil B	Interchangeabilité selon ISO 7241-1 part B

Fields of application
Settori di applicazione
Anwendungsbereiche
Domaines d'application



Size Base BG Taille	Working pressure Pressione di esercizio Betriebsdruck Pression de service	Flow Rate Portata Durchsatz Débit	Burst Pressures Pressione di scoppio Berstdruck Pression d'éclatement		
		@ 0,2 MPa pressure drop			
mm inch	MPa (PSI)	l/min (GPM)	MPa (PSI)	MPa (PSI)	MPa (PSI)
3 1/8"	50 (7500)	5 (1.3)	200 (30000)	280 (42000)	200 (30000)
6.3 1/4"	45 (6750)	17 (4.5)	180 (27000)	180 (27000)	200 (30000)
10 3/8"	30 (4500)	50 (13.2)	180 (27000)	130 (19500)	120 (18000)
12.5 1/2"	35 (5250)	75 (19.8)	150 (22500)	140 (21000)	140 (21000)
20 3/4"	25 (3625)	190 (50.2)	100 (14500)	110 (16500)	100 (14500)
25 1"	30 (4500)	270 (71.4)	120 (18000)	120 (18000)	120 (18000)
40 1 1/2"	14 (2100)	750 (198.4)	60 (9000)	56 (8400)	56 (8400)
50 2"	9 (1350)	1600 (423.3)	45 (6750)	38 (5700)	40 (6000)

Technical Specifications	Speci¿che Tecniche	Technischen Daten	Caractéristiques Techniques
High grade carbon steel with heat treated wear parts.	Acciaio ad alto tenore di carbonio con parti sollecitate, trattate termicamente	High Quality Karbonstahl Induktionsgeärtet in besonders beanspruchter Stress zone	Acier à haute teneur en carbone avec traitement thermique des pièces d'usure
NBR Backup ring in PTFE	NBR Anello antiestrusione PTFE	NBR Stützring in PTFE	NBR Anneau anti-extrusion en PTFE
-25°C to +125°C (-13°F to +257°F)	-25°C a +125°C (-13°F a +257°F)	-25°C to +125°C (-13°F to +257°F)	-25°C à +125°C (-13°F à +257°F)
Mate500®	Mate500®	Mate500®	Mate500®
According to ISO 7241-2	Secondo la norma ISO 7241-2	Nach ISO 7241-2	Selon la norme ISO 7241-2

Fema

mm

3

3

6.3

6.3

6.3

10

10

10

12.5

12.5

12.5

20

20

20

25

25

25

40

40

50

Male

S

B

T

mm.

3

3

6.3

6.3

6.3

10

10

12.5

12.5

12.5

20

20

20

25

25

25

40

40

50

Accessories - Accessori - Zubehör - Accessoires

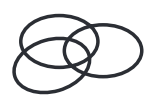
Size Base BG Taille		Dust protections Tappi Protezione Staubschutzteile Capuchons		Dust protections Tappi Protezione Staubschutzteile Capuchons		Seal Kits Guarnizioni di ricambio Ersatzdichtungen Joints		Package Confezione Verpackung Colis		
		PVC	Aluminum	PVC	Aluminum					
mm	inch	Part Number Codice Articolo Artikelnummer Désignation	Colour Colore Farbe Couleur	Part Number Codice Articolo Artikelnummer Désignation	Colour Colore Farbe Couleur					Part Number Codice Articolo Artikelnummer Désignation
3	1/8"	TFH 18	●			TMH 18	●		SK HNV 18	1*
6.3	1/4"	TFH 14	●			TMH 14	●		SK HNV 14	1*
10	3/8"	TFH 38	●			TMH 38	●		SK HNV 38	1*
12.5	1/2"	TFH 12	●			TMH 12	●		SK HNV 12	1*
20	3/4"	TFH 34	●			TMH 34	●		SK HNV 34	1*
25	1"	TFH 1	●			TMH 1	●		SK HNV 1	1*
40	1-1/2"								SK HNV 112	1**
50	2"								SK HNV 2	1**

* 10 O'rings + 10 PTFE rings ** 5 O'rings

Thread Filetto Anschluss Filetage

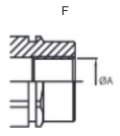

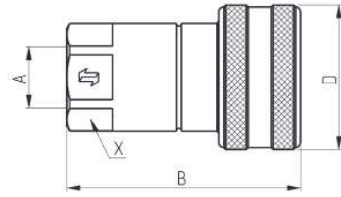

Female – Femmina – Muffe – Femelle :

Size Base BG Taille	Thread Filetto Anschluss Filetage	Part Number Codice Articolo Artikelnummer Désignation	A	B	D	X	Weight Peso Gewicht Poids	Package Confezione Verpackung Colis
mm	inch.		mm (in)	mm (in)	mm (in)	mm (in)	g (lbs)	No.
6.3	1/4"	F HNV 14 GAS F 2V	1/4" BSP Female	56 (2.20)	28 (1.10)	19 (0.75)		
6.3	1/4"	F HNV 14 NPT F 2V	1/4" NPTF Female	56 (2.20)	28 (1.10)	19 (0.75)		
10	3/8"	F HNV 38 GAS F 2V	3/8" BSP Female	64 (2.52)	35 (1.38)	24 (0.94)		
10	3/8"	F HNV 38 NPT F 2V	3/8" NPTF Female	64 (2.52)	35 (1.38)	24 (0.94)		
12.5	1/2"	F HNV 12 GAS F 2V	1/2" BSP Female	72 (2.83)	44 (1.73)	30 (1.18)		
12.5	1/2"	F HNV 12 NPT F 2V	1/2" NPTF Female	72 (2.83)	44 (1.73)	30 (1.18)		
20	3/4"	F HNV 34 GAS F 2V	3/4" BSP Female	89 (3.50)	52 (2.05)	36 (1.42)		
20	3/4"	F HNV 34 NPT F 2V	3/4" NPTF Female	89 (3.50)	52 (2.05)	36 (1.42)		
25	1"	F HNV 1 GAS F 2V	1" BSP Female	106 (4.17)	62 (2.44)	41 (1.61)		
25	1"	F HNV 1 NPT F 2V	1" NPTF Female	106 (4.17)	62 (2.44)	41 (1.61)		
40	1-1/2"	F HNV112 GAS F 2V	1-1/2" BSP Female	126 (4.96)	75 (2.95)	65 (2.56)		
50	2"	F HNV 2 GAS F 2V	2" BSP Female	142 (5.59)	105 (4.13)	89 (3.50)		

ISO A - ISO B - Standard
ISO A - ISO B - Standard
ISO A - ISO B - Standard
ISO A - ISO B - Standard

Agriculture
Agricoltura
Agriculture
Ausführung Agrartechnik
Agriculture

Screw Together
Innesti a Vite
Schraubkupplungen
A Visser

Check Valves
Valvole Unidirezionali
Rückschläventile
Clapet Anti-retour

Diagnostic
Diagnostici
Diagnostik Kupplung
Diagnostic

Flat Face
Innesti Faccia Piana
Flachdichtend
Clapet à Face Plat

Multifaster
Multiconnessioni
Multikupplungen
Multifaster

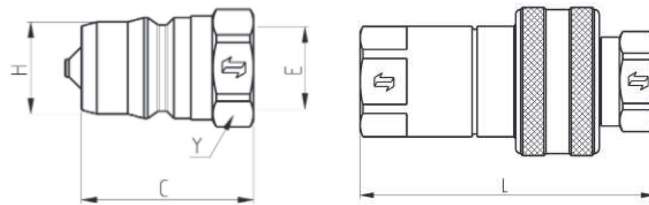

Male – Maschio – Stecker – Male :

Size Base BG Taille	Thread Filetto Anschluss Filetage	Part Number Codice Articolo Artikelnummer Désignation	E	C	L	H	Y	Weight Peso Gewicht Poids	Package Confezione Verpackung Colis
mm	inch.		mm (in)	mm (in)	mm (in)	mm (in)	mm (in)	g (lbs)	No.
6.3	1/4"	F HNV 14 GAS M 2V	1/4" BSP Female	35 (1.38)	B+C-21 (0.83)	14.1 (0.55)	19 (0.75)		
6.3	1/4"	F HNV 14 NPT M 2V	1/4" NPTF Female	35 (1.38)	B+C-21 (0.83)	14.1 (0.55)	19 (0.75)		
10	3/8"	F HNV 38 GAS M 2V	3/8" BSP Female	39 (1.54)	B+C-25 (0.98)	19 (0.75)	22 (0.87)		
10	3/8"	F HNV 38 NPT M 2V	3/8" NPTF Female	39 (1.54)	B+C-25 (0.98)	19 (0.75)	22 (0.87)		
12.5	1/2"	F HNV 12 GAS M 2V	1/2" BSP Female	44 (1.73)	B+C-28 (1.10)	23.5 (0.92)	27 (1.06)		
12.5	1/2"	F HNV 12 NPT M 2V	1/2" NPTF Female	44 (1.73)	B+C-28 (1.10)	23.5 (0.92)	27 (1.06)		
20	3/4"	F HNV 34 GAS M 2V	3/4" BSP Female	55 (2.16)	B+C-34 (1.34)	31.4 (1.24)	34 (1.34)		
20	3/4"	F HNV 34 NPT M 2V	3/4" NPTF Female	55 (2.16)	B+C-34 (1.34)	31.4 (1.24)	34 (1.34)		
25	1"	F HNV 1 GAS M 2V	1" BSP Female	66 (2.60)	B+C-40 (1.57)	37.8 (1.49)	41 (1.61)		
25	1"	F HNV 1 NPT M 2V	1" NPTF Female	66 (2.60)	B+C-40 (1.57)	37.8 (1.49)	41 (1.61)		
40	1-1/2"	F HNV112 GAS M 2V	1-1/2" BSP Female	126 (4.96)	B+C-54 (2.13)	44.5 (1.75)	65 (2.56)		
50	2"	F HNV 2 GAS M 2V	2" BSP Female	142 (5.59)	B+C-65 (2.56)	63.2 (2.49)	89 (3.50)		



ISO A - ISO B - Standard
ISO A - ISO B - Standard
ISO A - ISO B - Standard
ISO A - ISO B - Standard

Agriculture
Agricoltura
Agriculture
Agriculture

Screw Together
Innesti a Vite
Schraubkupplungen
A Visser

Check Valves
Valvole Unidirezionali
Rückschläventile
Clapet Anti-retour

Diagnostic
Diagnostici
Diagnostik Kupplung
Diagnostic

Flat Face
Innesti Faccia Piana
Flachdichtend
Clapet à Face Plat

Multifaster
Multiconnessioni
Multikupplungen
Multifaster

Features	Caratteristiche	Merkmale	Caractéristiques
Connection by pulling back the sleeve	Connessione mediante arretramento ghiera parte femmina	Kupplern durch Einstecken des Kupplungssteckers	Connexion en poussant le coupleur mâle
Disconnection by pulling back the female sleeve	Disconnessione mediante arretramento ghiera parte femmina	Entkuppeln, durch Zurückziehen der Verriegelungshülse	Déconnexion en en tirant la bague femelle
Shut off by poppet valve	Sistema di tenuta mediante valvola	Verschluss durch nachdichtendes Ventil	Système d'étanchéité a clapet standard
Connection under pressure not allowed	Connessione in pressione non consentita	Kupplern unter Druck nicht erlaubt	Connexion sous pression non autorisée
Disconnection under pressure not allowed	Disconnessione in pressione non consentita	Entkuppeln unter Druck nicht erlaubt	Déconnexion sous pression non autorisée
Interchangeability according to ISO 7241-1 Part B	Intercambiabilità secondo norme ISO 7241-1 Part B	Austauschbarkeit gemäß ISO 5271-1 Teil B	Interchangeabilité selon ISO 7241-1 part B

Fields of application
Settori di applicazione
Anwendungsbereiche
Domaines d'application



Size Base BG Taille		Working pressure Pressione di esercizio Betriebsdruck Pression de service	Flow Rate Portata Durchsatz Débit	Burst Pressures Pressione di scoppio Berstdruck Pression d'éclatement		
		@ 0,2 MPa pressure drop				
m.m	inch	MPa (PSI)	l/min (GPM)	MPa (PSI)	MPa (PSI)	MPa (PSI)
3	1/8"	22 (3175)	6 (1.6)	90 (13050)	140 (20300)	150 (21750)
6.3	1/4"	20 (2900)	16 (4.2)	80 (11600)	120 (17400)	120 (17400)
10	3/8"	15 (2175)	25 (6.6)	60 (8700)	70 (10150)	100 (14500)
12.5	1/2"	17 (2450)	60 (15.9)	70 (10150)	90 (13050)	90 (13050)
20	3/4"	10 (1450)	110 (29.0)	40 (5800)	50 (7250)	102 (14775)
25	1"	14 (2025)	150 (39.6)	56 (8100)	58 (8400)	80 (11600)
40	1 1/2"	7 (1000)	750 (198.4)	30 (4350)	33 (4775)	40 (5800)
50	2"	6 (850)	1600 (423.0)	25 (3625)	27 (3900)	31 (4475)

Technical Specifications		Speci¿che Tecniche	Technischen Daten	Caractéristiques Techniques
	Brass	Ottone	Messing	Laiton
	NBR	NBR	NBR	NBR
	-25°C to +125°C (-13°F to +257°F)	-25°C a +125°C (-13°F a +257°F)	-25°C to +125°C (-13°F to +257°F)	-25°C à +125°C (-13°F à +257°F)
	According to ISO 7241-2	Secondo la norma ISO 7241-2	Nach ISO 7241-2	Selon la norme ISO 7241-2

Fema

mm.

3

3

6.3

6.3

10

10

12.5

12.5

20

20

25

25

40

40

50

Male

S

E

T

mm.

3

3

6.3

6.3

10

10

12.5

12.5

20

20

25

25

40

50

ISO A - ISO B - Standard
ISO A - ISO B - Standard
ISO A - ISO B - Standard
ISO A - ISO B - Standard

Agriculture
Agricoltura
Agriculture
Ausführung Agrartechnik
Agriculture

Screw Together
Innesti a Vite
Schraubkupplungen
A Visser

Check Valves
Valvole Unidirezionali
Rückschläventile
Clapet Anti-retour

Diagnostic
Diagnostici
Diagnostik Kupplung
Diagnostic

Flat Face
Innesti Faccia Piana
Flachdichtend
Clapet à Face Plat

Multifaster
Multiconnessioni
Multikupplungen
Multifaster

Accessories - Accessori - Zubehör - Accessoires

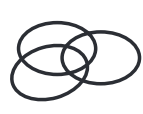
Size Base BG Taille		Dust protections Tappi Protezione Staubschutzteile Capuchons				Dust protections Tappi Protezione Staubschutzteile Capuchons				Seal Kits Guarnizioni di ricambio Ersatzdichtungen Joints		Package Confezione Verpackung Colis	
		PVC		Aluminum		PVC		Aluminum					
mm	inch.	Part Number Codice Articolo Artikelnummer Désignation	Colour Colore Farbe Couleur	Part Number Codice Articolo Artikelnummer Désignation	Part Number Codice Articolo Artikelnummer Désignation	Colour Colore Farbe Couleur	Part Number Codice Articolo Artikelnummer Désignation	Part Number Codice Articolo Artikelnummer Désignation	Part Number Codice Articolo Artikelnummer Désignation				
3	1/8"	TFH 18	●		TMH 18	●				SK HNV 14	1*		
6.3	1/4"	TFH 14	●		TMH 14	●				SK HNV 14	1*		
10	3/8"	TFH 38	●		TMH 38	●				SK HNV 38	1*		
12.5	1/2"	TFH 12	●		TMH 12	●				SK HNV 12	1*		
20	3/4"	TFH 34	●		TMH 34	●				SK HNV 34	1*		
25	1"	TFH 1	●		TMH 1	●				SK HNV 1	1*		
40	1-1/2"									SK HNV 112	1**		
50	2"									SK HNV 2	1**		

* 10 O'rings + 10 PTFE rings ** 5 O'rings

Thread Filetto Anschluss Filetage

F

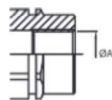

Feat
sleeve

Discon
female

Shut o
Conne
allowe

Discon
allowe
Interd

Fields
Setto
Anwe
Doma

- mm
- 6.3
- 10
- 12.5
- 20
- 25
- 31.5
- 40
- 50

